

2 Basic House Designs

Text, Pages 37–50

Name _____

Course _____ Date _____ Score _____

Part I: Multiple Choice

Select the best answer and write the corresponding letter in the space provided.

1. Which of the following is a feature of the one-story ranch design? 1. _____
 - A. Minimal heating costs.
 - B. Economical to build.
 - C. Easily adapted to indoor-outdoor living.
 - D. Limited hall space.

2. Which of the following basic house designs is suitable for older or handicapped persons? 2. _____
 - A. One-story ranch.
 - B. One-and-one-half-story.
 - C. Two-story.
 - D. Split-level.

3. Outside maintenance is generally easy on a one-story ranch design because: 3. _____
 - A. It has a small outside wall area.
 - B. It has a low-pitched roof.
 - C. It is built on a sloping lot.
 - D. All of the above.

4. Dormers are usually added to this design to achieve more livable space. 4. _____
 - A. One-story ranch.
 - B. One-and-one-half-story.
 - C. Two-story.
 - D. Split-level.

5. Advantages of the one-and-one-half-story design include: 5. _____
 - A. The attic may be expanded to achieve more livable space.
 - B. Dormers may be added for light and ventilation.
 - C. Heating costs are minimized.
 - D. All of the above.

6. Which of the following best describes a two-story design?

- A. Little hall space is needed, and the sleeping, living, and service areas are on different levels.
- B. About one-third of the ceiling is directly under the roof, so adequate ventilation and insulation should be provided.
- C. It is economical to build, it requires a smaller lot, and it has a small roof and foundation area compared to the interior space of most other designs.
- D. It is built on one level. Thus, patios, porches, and terraces are possible outside any room.

7. Advantages of the two-story design include:

- A. Heating is relatively simple and economical because heat naturally rises from the first to the second floor.
- B. The style is popular today because many variations on the basic design are possible.
- C. Exterior maintenance is simple and requires no special equipment.
- D. All of the above.

8. This house design lends itself to easy cooling since the ceiling is not directly under the roof. Several windows provide effective ventilation.

- A. One-story ranch.
- B. One-and-one-half-story.
- C. Two-story.
- D. Split-level.

9. Which of the following house designs takes advantage of a sloping or hilly lot?

- A. One-story ranch.
- B. One-and-one-half-story.
- C. Two-story.
- D. Split-level.

10. The family room, garage, and foyer are commonly found on this level in a split-level design:

- A. Basement level.
- B. Intermediate level.
- C. Living level.
- D. Sleeping level.

6. _____

7. _____

8. _____

9. _____

10. _____

Name _____

11. Which of the following is a feature of the split-level design? 11. _____
- A. It easily accommodates patios and terraces in the recreation area.
 - B. The design makes efficient use of space.
 - C. It may be built with either a basement or crawl space.
 - D. All of the above.

Part II: Short Answer/Listing

Provide brief answers to the following questions.

1. Without proper design and planning, heating may be a problem in a split-level design. What steps may be taken to solve the problem? _____

2. Name the three variations of the split-level design. _____

3. Which variation of the split-level design is most suitable for a lot that is high in front and low in back? _____
4. What is unique about the entry of a traditional split-level? _____

5. Traffic circulation should be planned for maximum efficiency. Explain why the foyer and garage play an important role in planning a house. _____

6. Name the four basic house designs. _____

Part III: Problems/Activities

1.

Directions:

Show the traffic circulation through the major living areas of the home below. Study the example in the text to see how traffic circulation is represented on a plan.

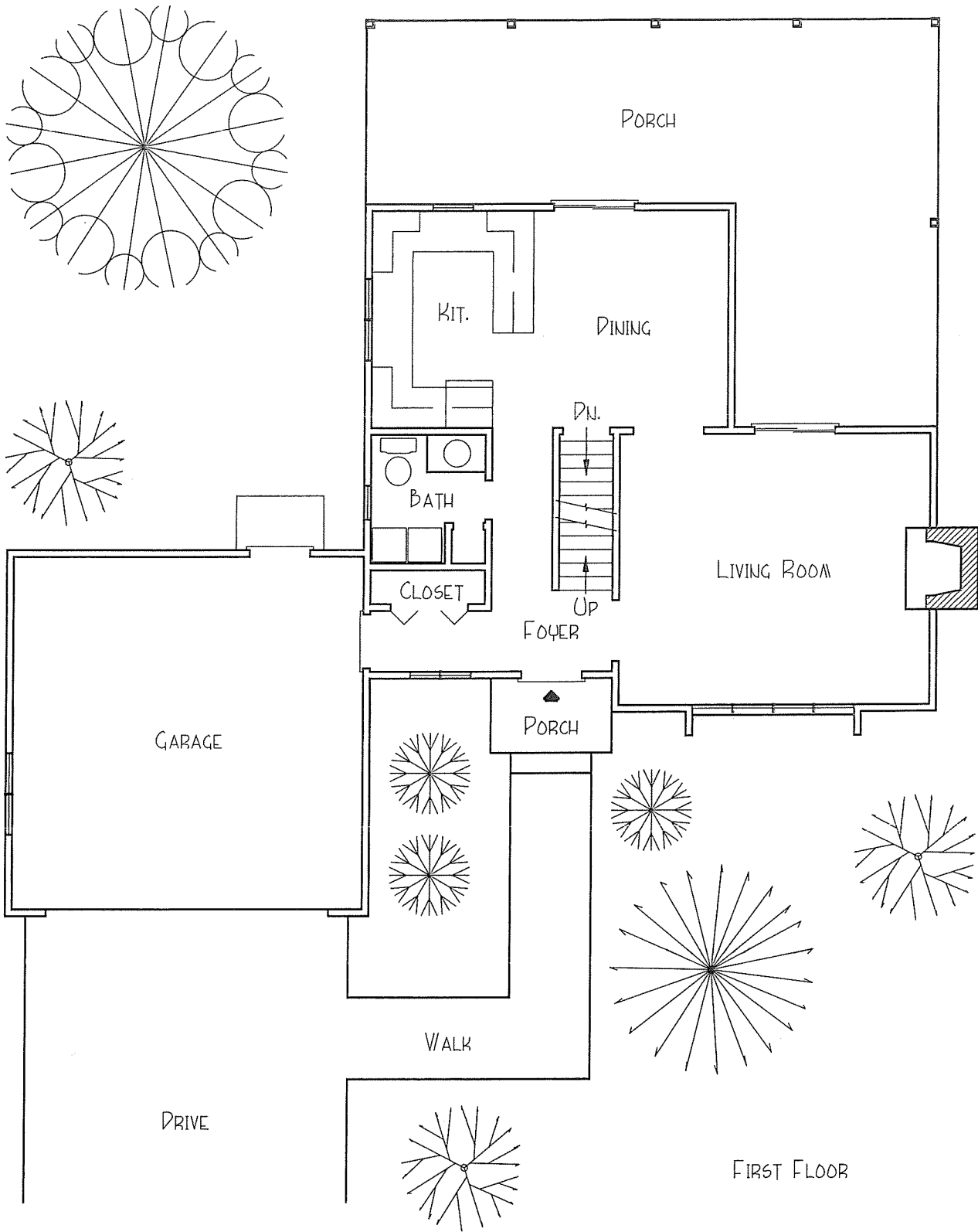

TRAFFIC CIRCULATION

NAME:

2-1